

LÍNEA PARA ***TORCHAS U***

TORCHAS UNIVERSALES

S75 Low Frequency Air Cooled Plasma Torch Rating:70A

No.	Order No.	Description
1	WS75	Cuerpo Torch Hand
2	THTRF FH647	Air Tube
3	THTRF PR117	Electrode-Hf
3	THTRF PR119	Electrode Large
4	THTRF PR112	Swirl Ring
5	THTRF PD114-10	Tip,1.0mm
5	THTRF PD118-10	Tip Large
	THTRF PD114-12	Tip,1.2mm
6	THTRF PC114	Nozzle Retaining Cap
7	THTRF CV76	Spacer
	WS 76	Cuerpo de torcha s/empuñadura
	WS 77	Switch
	WS 78	Empuñadura de torch S75
	WS 79	Torch Hand S75 C/Cable 4mts. 3/8

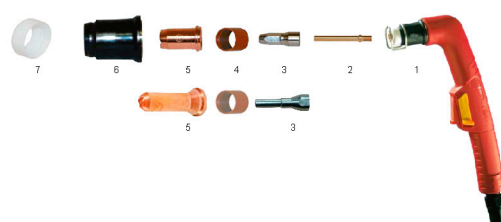

S105 Low Frequency Air Cooled Plasma Torch Rating:100A

No.	Order No.	Description
1	WS105	Cuerpo de Torcha Hand
2	THTRF FH647	Air Tube
3	THTRF PR117	Electrode-Hf
4	THTRF PE112	Swirl ring
5	THTRF PD119-12	Tip,1.2mm
	THTRF PD119-14	Tip,1.4mm
6	THTRF PC118	Nozzle Retaining Cap



A81 High Frequency Air Cooled Plasma Torch Rating:100A/140A

No.	Order No.	Description
1	WPF119	Cuerpo Torch Hand
2	THTRFPR107	Electrodo
	THTRFPR109	Electrodo
	THTRFPR108	Electrodo Largo
	THTRFPR115	Electrodo Largo
3	THTRFPE107	Aislante
4	THTRFPD105-110	Tobera 1.0mm.
	THTRFPD105-110	Tobera 1.2mm.
	THTRFPD106-10	Tobera Larga 1.0mm.
5	THTRFPC115	Retaining Cap
	THTRFCV28	Separador
	THTRFCV33	Separador
	THTRF1356	Empuñadura
	WPF122	Torch Machine A81 C/Cable 8 Mts. 3/8
	WPF121	Torch Machine A81 C/Cable 4 Mts. 3/8
	WPF120	Cuerpo Torch Machine A81
	WPF123	Empuñadura Torch Hand S/Empuñadura



TORCHAS UNIVERSALES

A90

Rating:100A/140A

No	Order No.	Description
1	W PF109	Torch Head
2	THTRF PR109	Electrode-hf
3	THTRF PE101	Swirl Ring
4	THTRF PD101	Tip,1.1mm
	THTRF PD101-11	Tip,1.4mm
	THTRF PD101-14	Tip,1.7mm
5	THTRF PC 115	Retaining Cap
7	CV11	Spacer
6	THTRF FH561	Difusor

Hand Torch 781 C/cable 4mts. 3/8

Cuerpo Torch Machine

Torch Machine A81 C/cable 8Mts. 3/8



A101

Air Cooled Plasma Cutting Torch

Rating:140A

No.	Order No.	Description
1	WPF 145	Cuerpo Torch Hand
2	THTRF PR 101	Electrodo
3	THTRF PE101	Swirl Ring
4	THTRF PD 101-11	Nozzle 1.1
	THTRF PD 101-14	Nozzle 1.4
	THTRF PD 101-17	Nozzle 1.7
5	THTRF PC 101	Retaining Cap
6	THTRF FH563	Difusor
7	CV11	Spacer
	WPF147	Torch Hand A101 C/Cable 4Mts.
	WPF 148	Torch Machine A101 C/Cable 8Mts.
	WPF 146	Empuñadura Torch Hand 101
	WPF 144	Cuerpo Torch S/Empuñadura 101
	WPF 115	Cuerpo Torch Machine
	THTRF PR 116	Electrodo Long

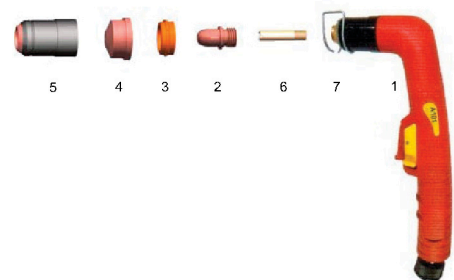

A140

Air Cooled Plasma Cutting Torch

Rating:140A

No.	Order No.	Description
1	WPF 145	Cuerpo Torch Hand
2	THTRF FH563	Difusor
3	THTRF PR101	Electrode
4	THTRF PE101	Swirl Ring
5	THTRF PD101-11	Nozzle 1.1mm
	THTRF PD101-14	Nozzle 1.4mm
	THTRF PD101-17	Nozzle 1.7mm
	THTRF PD101-19	Nozzle 1.9mm
6	THTRF PC101	Retaining Cap
	WPF 102	Hand Torch A141 c/cable 4 Mts.
	WPF 103	Torch Machine A141 c/cable 8 Mts.
7	CV11	Spacer



TORCHAS UNIVERSALES

CP40

Air Cooled Plasma Cutting Torch Rating:40A

No	Order No.	Description
1	THCEB 1359	Cuerpo Torch Hand
2	THCEB 1516	Electrode-Hf
3	THCEB 1507	Swirl Ring
4	THCEB 1290	Tip,0.7mm
5	THCEB 1906	Nozzle Retaining Cap



CP50

Air Cooled Plasma Cutting Torch Rating:50A

No.	Order No.	Description
1	WCP50	Cuerpo Torch Hand
2	THCEB 1521	Electrode-Hf
3	THCEB 1510	Swirl Ring
4	THCEB 1304	Nozzle 1.0mm
5	THCEB 5710121	Retaining Cap
6	THCEB 1518-Hf	Electrodo Largo
7	THCEB 1370	Nozzle Largo
	WCP51	Cuerpo de Torch Hand S/Empuñadura
	WCP52	Torch Hand CP50 Cable 4 Mts.



CP70

Air Cooled Plasma Cutting Torch Rating:70A

No.	Order No.	Description
1	WCP70	Cuerpo Torch Hand
2	THCEB 1402	Electrodo
3	THCEB 1510	Swirl Ring
4	THCEB 1308	Nozzle
7	THCEB 1396	Nozzle Largo
5	THCEB 5710171	Retaining Cap
6	THCEB 1403	Electrodo Largo
8	THCEB 1349	Cuerpo torch machine c/empuñadura
	THCEB 1355	Empuñadura Torch Machine
	WCP71	Torch Hand cp70 Cable 4Mts - 3/8
	WCP72	Torch Machine - Cable 8Mts - 3/8



TORCHAS UNIVERSALES

CB150 Air Cooled Plasma Cutting Torch Rating:150A

No.	Order No.	Description
1	WCB150	Cuerpo Torch Hand
2	THCEB1378	Difusor
3	THCEB1376	Electrode
4	THCEB1377	Swirl Ring
5	THCEB1371	Nozzle 1.1mm
	THCEB1372	Nozzle 1.3mm
	THCEB1373	Nozzle 1.6mm
	THCEB1374	Nozzle 1.8mm
6	THCEB1389	Retaining Cap
	WMCB150	Hand Torch Comp. 6 mts.
	WMCB151	Empuñadura Hand Torch
	WCB1357	Empuñadura Torch Machine
7	WCB1354	Cuerpo de torch Machine

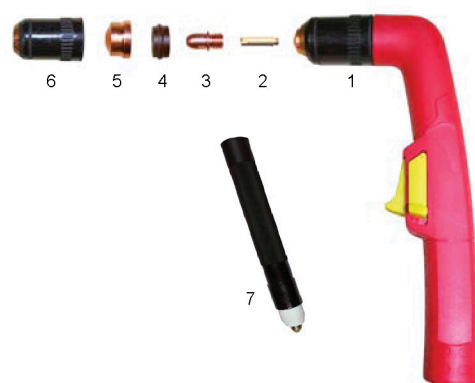

PT31 (JG-40) Air Cooled Plasma Cutting Torch Rating:40A

No.	Order No.	Description
1	W20072	Cuerpo Torch
2	W18205	Electrode
3	W19683	Electrodo largo
4	W18785	Swirl Ring
5	W18866	Nozzle Corto
6	W19682	Nozzle Largo
7	W18204	Shield Cup
8	W20073	Torcha completa 6 mts.
	W20074	Torcha completa 4 mts.

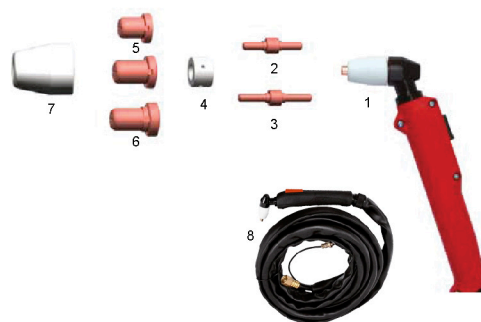

SG55 (AG-60) Air Cooled Plasma Cutting Torch Rating:60A

No.	Order No.	Description
1	WSG5501	Cuerpo Hand
2	WSG5502	Electrode
3	WSG5504	Tip
4	WSG5505	Shield Cup Lisa
	WSG5506	Shield Cup c/ranura
	WSG5500	Torch Hand c/cable 4mts. 5655
	WSG5507	Spacer 565



TORCHAS UNIVERSALES

SG51

Air Cooled Plasma Cutting Torch Rating:50A

No.	Order No.	Ref.No.	Description
1	W SG5101		Cuerpo Torch Hand
2	W SG5102		Electrode
3	W SG5103		Swirl Ring
4	W SG5104		Tip 1.0mm
6	W SG5105		Retaining Cap
7	W SG5100		Torch Hand C/Cable 4mts.

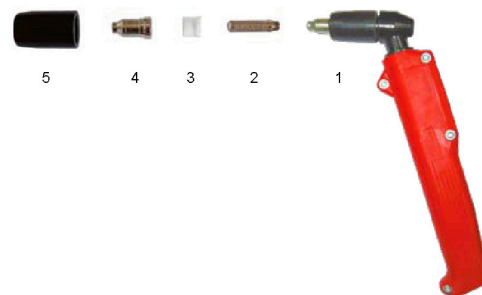

PT100

No	Order No.	Description
1	W 09732	Cuerpo Torch Hand
	W 09731	Torch Machine C/Cable/3m
	W 09736	Hand Torch C/Cable/6m
2	W 09730	Cuerpo Torch Machine S/Cable
3	W 52557	Electrode
5	W 51246	Nozzle 1.2 mm
	W 51248	Nozzle 1.5 mm
4	W 60026	Swirl Ring
6	W 60501	Retaining Cap
7	W 52560	Distanciador
	W 09733	Cuerpo de torcha S/Mango
	W 09734	Torch Machine C/Cable 6mts.

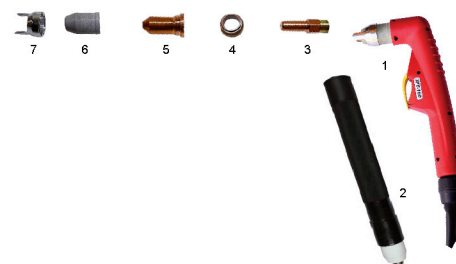

PT80

No	Order No.	Description
1	W 8001	Cuerpo Torch Hand
2	W 8004	Electrode
3	W 8007	Swirl Ring
4	W 8005 09	Nozzle 0,9 mm
	W 8005 10	Nozzle 1 mm
	W 8005 12	Nozzle 1,2 mm
5	W 8008	Retaining Cap
6	W 8009	Distanciador
	W 8002	Cuerpo de torcha Hand S/Empuñadura
7	W 8010	Hand machine
	W 8011	Torch Machine C/Cable 6Mts.



PT 25|40|60

No	Order No.	Description
1	W 2200	Cuerpo Torch Hand
2	W 2211	Electrode
3	W 221009	Nozzle 09 mm
	W 221010	Nozzle 1,0 mm
	W 221011	Nozzle 1,1 mm
	W 221012	Nozzle 1,2 mm
4	W 2213	Swirl Ring
5	W 2212	Retaining Cup
	W 2214	Shield Cup
7	W 2215	Distanciador
	W 2201	Cuerpo de torcha Hand S/Empuñadura
	W 2202	Torch Hand 3 mts.

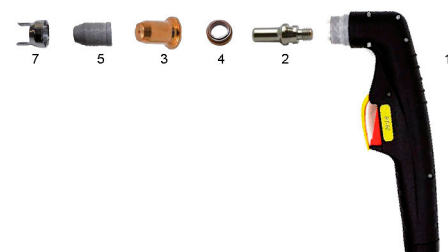

TORCHAS UNIVERSALES

ME50

Air Cooled Plasma Cutting Torch Rating:50A

No.	Order No.	Description
1	W ME5001	Cuerpo Torch Hand
2	W ME5002	Electrode
3	W ME5003	Swirl Ring
4	W ME5004	Nozzle
5	W ME5005	Shield Cup

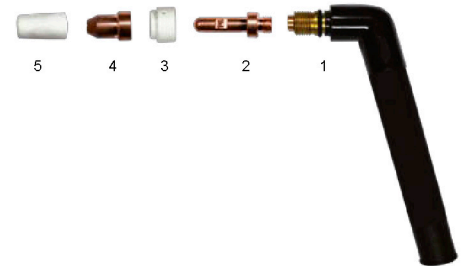

TC60

Rating:60A

No.	Order No.	Description
1	W 08540	Cuerpo Torch Hand
	W 08543	Torch Hand c/cable 3 mts
	W 08546	Torch Hand c/cable 6 mts
2	W 08541	Cuerpo Torch Machine
3	W 41150	Electrode
4	W 41151	Nozzle
5	W 41152	Swirl Ring
6	W 41153	Shield Cup



TC100

Rating:100A

No.	Order No.	Description
1	W JG10001	Torch Hand
2	W JG10002	Electrodo Corto
3	W JG10003	Electrodo Largo
4	W JG10004	Nozzle
5	W JG10005	Swirl Ring
6	W JG10006	Shield Cup



TORCHAS UNIVERSALES

PLASMAIRE 50

No.	Order No.	Description
1	W 3001	Electrodo
2	W 3002	Noozle
3	W 3003	Swirl Ring
4	W 3004	Shield Cap

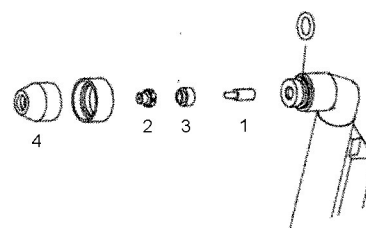

PLASMAIRE 80

No	Order No.	Description
1	W 7001	Electrodo
2	W 7002	Nozzle
3	W 7003	Swirl Ring
4	W 7004	Shield Cup
5	W 7005	Spacer String

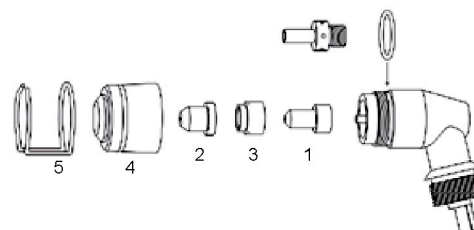

PLASMAIRE 100|120

No.	Order No.	Description
1	4001	Electrodo Plasmaire 100/120
4	4007	Electrodo Plasmaire 120
5	4002	Nozzle 100/120
6	4003	Shield Cap. Plasmaire 100/120
3	4004	Spacer Plasmaire 100/120
4	4005	Swirl Ring 100
	4006	Swirl Ring 120

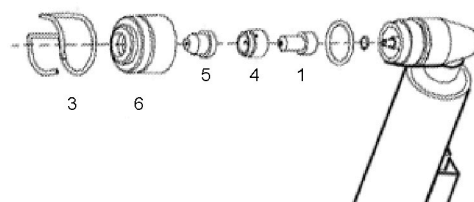

KAMI 25/70

No	Order No.	Description
1	W 7006	Electrodo largo
1	W 7008	Electrodo corto
2		Retaining cap
3	W 7009	Nozzle corto
3	W 7007	Nozzle Largo
4	W 7003	Swirl Ring
5	W 7005	Spacer
6		Cuerpo de Torch Hand

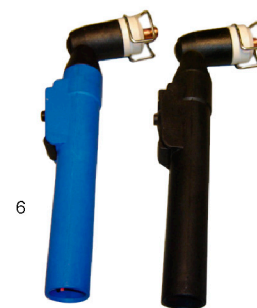

KAMI 70/120

No	Order No.	Description
1	W 9001	Electrodo
3	W 9002	Nozzle
4	W 9003	Swirl Ring
2	W 9004	Retaining cap
5	W 9005	Spacer
6		Cuerpo de Torch Hand



TORCHAS UNIVERSALES

PAN OCEAN

No.	Order No.	Description
1	WEFY160	Electrodo Rosca Fina
	WEFY160	Electrodo Rosca Gruesa
2	WTFFY160	Torch Machine r/fina
	WTGFY160	Torch Machine R/Gruesa
3	WTFY160	Nozzle Rosca Fina
	WTFY160	Nozzle Rosca Gruesa
4	WRFY160	Retaining Cup
5	WRFY160	Shield Cup



FANYANG 200

Water Cooled Plasma
Cutting Torch
Rating:200A

No.	Order No.	Description
1	W FY20001	Torch Head
2	W FY20002	Electrode
3	W FY20003	Swirl Ring
4	W FY20004	Nozzle
5	W FY20005	Inner Shield
6	W FY20006	Shield Cup

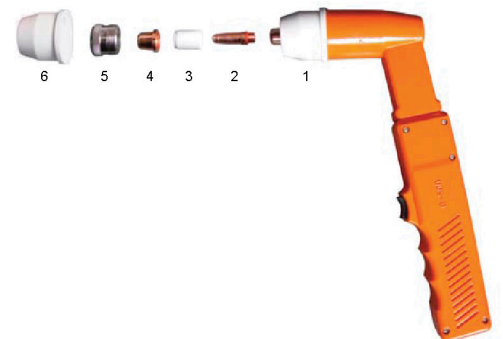

SPC50

Air Cooled Plasma Cutting Torch Rating:50A

No	Order No.	Description
	W SPC5001	Torch Head
	W SPC5002	Electrode
	W SPC5003	Swirl Ring
	W SPC5004	Nozzle
	W SPC5005	Shield Cup

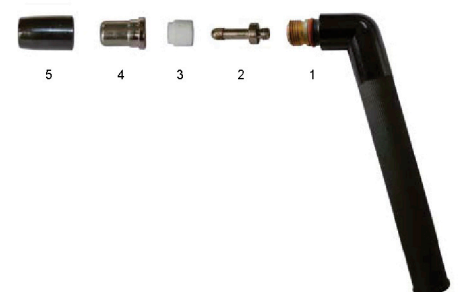

SP60

Air Cooled Plasma Cutting Torch Rating:60A

No	Order No.	Description
1	W SP6001	Hand Torch Head
2	W SP6002	Gas Cooling Tube
3	W SP6003	Electrode
4	W SP6005	Nozzle
5	W SP6006	Shield Cup



TORCHAS UNIVERSALES

YK100-H

No.	Order No.	Description
1	WYK 100	Cuerpo torch machine
2	WYK 100	Electrode
3	WYK 10012	Nozzle 1.2
3	WYK 10016	Nozzle 1.6
3	WYK 10018	Nozzle 1.8
4	WYK 100 104	Shield
7	WYK 100 107	Cooling tube
5	WYK 100 105	Shield cap
6	WYK 100 TM	Torch machine 8mts. Yk100
6	WYK 100 106	Retaining cap



YK200-H

No.	Order N°	Description
1	WYK 200M	Cuerpo torch machine
2	WYK 200M	Electrode
3	WYK 200 18	Nozzle 1,8
3	WYK 200 22	Nozzle 2,2
3	WYK 200 25	Nozzle 2,5
4	WYK 200 104	Shield
5	WYK 200 105	Shield cap
6	WYK 200 106	Retaining cap
7	WYK 200 17	Cooling tube



YK330

N°	Order N°	Description
1	WYK 02211	Electrodo 300-400 A
1	WYK 02201	Electrodo 30-300 A
	WYK 02301	Swirl Ring 30-300A
4	WYK 02413	Nozzle 1.3 mm 40-160 A
4	WYK 02415	Nozzle 1.5 mm 40-160 A
4	WYK 02417	Nozzle 1.7 mm 40-160 A
4	WYK 02419	Nozzle 1.9 mm 120-200
4	WYK 02423	Nozzle 2.3 mm 120-200
4	WYK 02425	Nozzle 2.5 mm 180-300
4	WYK 02428	Nozzle 2.8 mm 200-300
4	WYK 02432	Nozzle 3.2 mm 200-400
2	WYK 02501	Iner Cap. 300 A
5	WYK 02601	Retaining Cap. 300 A
6	WYK 02701	Shield 300A
7	WYK 02711	Shield Cap. 300A
3	WYK 02101	Cooling Tube



TORCHAS UNIVERSALES

P80 Air Cooled Plasma Cutting Torch (Pana) Rating:100A

No	Order No.	Description
1	WYT-10PD	Cuerpo Torch Manual
2	WTET02033	Electrode
3	WTET01110	Tip ø 1.0- 40A
	WTET01130	Tip ø 1.3- 60A
	WTET01512	Tip ø 1.5- 80A
4	WTET00812	Tip ø 0.8
	WTET01809	Tip ø 1.7- 100A
5	WTGN02004	Shield Cup
	WYT-10PE	Cuerpo Torch
	WP80R	Machine Torch Head 6 mts
	WP80M4	Hand Torch 4 mts
	WP80M6	Hand Torch 6 mts
	WP80C	Cables



P160 Water Cooled Torch Rating:160-200A

No.	Order No.	Description
1	WP16000	Cuerpo Torch Manual
2	WP16001	Electrode-Short
3	WP16002	Electrode-Long
4	WP16003	Nozzle
5	WP16004	Shield
6	WP16005	Cuerpo Torch Machine

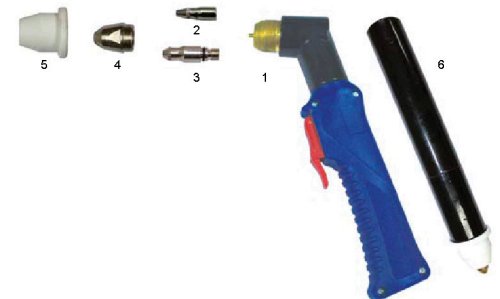

S25/S30/S45

Low Frequency Air Cooled Plasma Torch Rating:40A

No.	Order No.	Description
1	WS45	Torch Head 545/530
2	WS46	Cuerpo Torch S/Empuñadura
3	THTRF PR110	Electrode,20-30A
4	THTRF PE106	Swirl Ring
5	THTRF PD102-10	Nozzle, 1.0mm,40A
6	THTRF PD116-08	Long Nozzle,20-30A
7	THTRF PC116	Shield
	WS 25	T. Hand c/cable 4 mts. Rosca 3/8
	WS 48	T. Hand c/cable 4 mts. Rosca 3/8
	WS 47	Empuñadura Torch Hand

