

LÍNEA *Hypertherm*[®]

LÍNEA Hypertherm®

**POWERMAX
30**

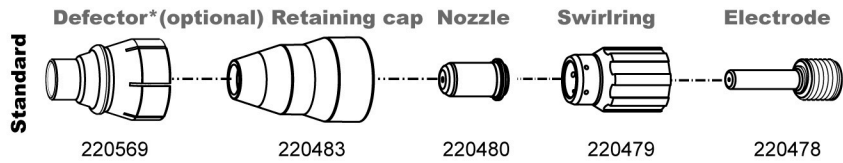

**POWERMAX
45**

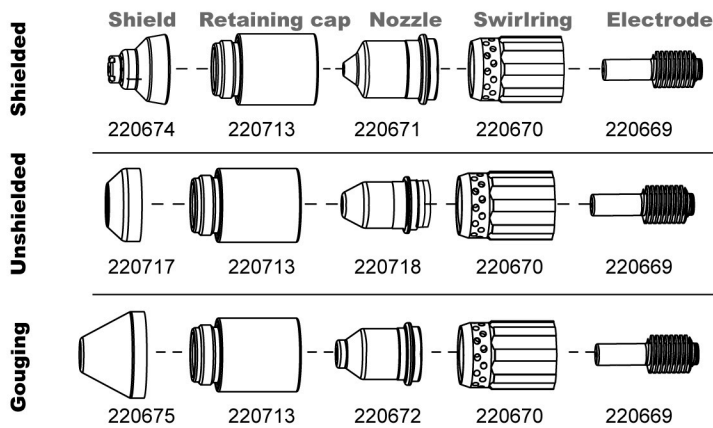

**POWERMAX
65**

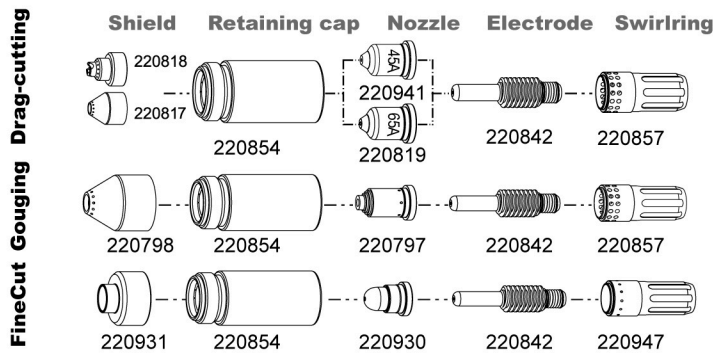

LÍNEA Hypertherm®

**POWERMAX
200**

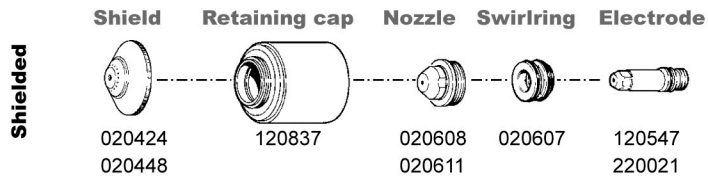

**POWERMAX
1250**

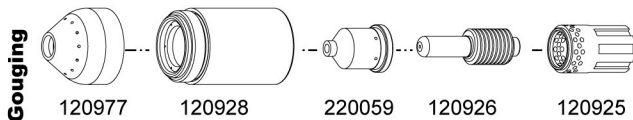
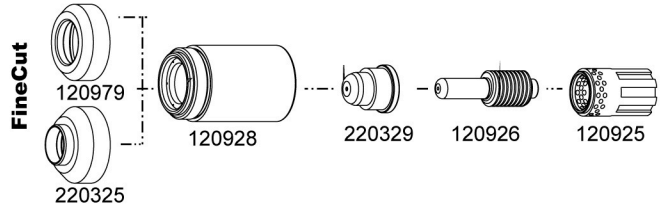
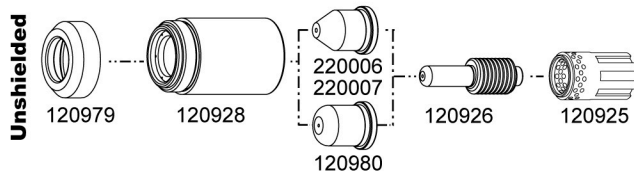
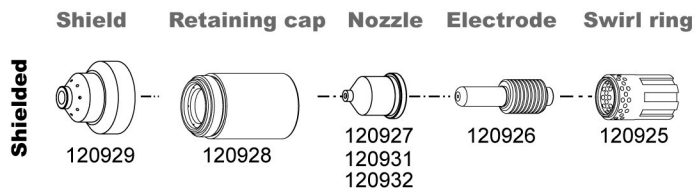

**POWERMAX
1650**

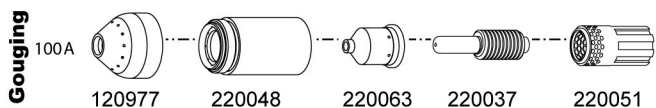
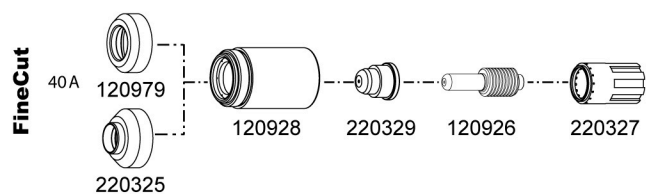
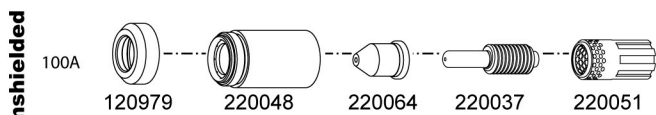
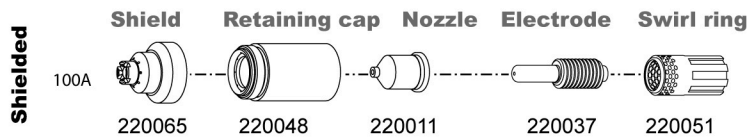

LÍNEA Hypertherm®

**HPR
130**

**HPR
260**

	Shield cap	Shield	Retaining cap	Nozzle	Swirl ring	Electrode
30 A	220173	220194	220313	220193	220180	220192
50 A	220173	220555	220313	220554	220553	220552
80 A	220173	220189	220176	220188	220179	220187
130A	220173	220183	220176	220182	220179	220181
Mild steel						
200A		220356	220355	220354	220353	220352
260A	220398	220440	220433	220439	220436	220435
130A bevel	220398	220645	220603	220646	220179	220649
260A bevel	220398	220545	220603	220542	220436	220541

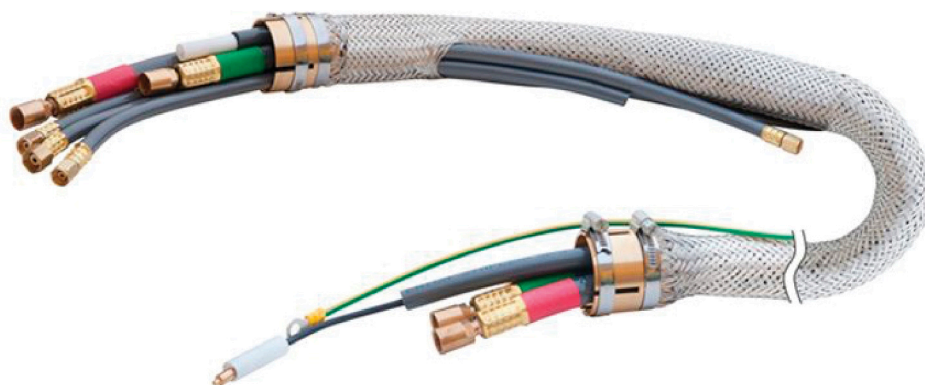
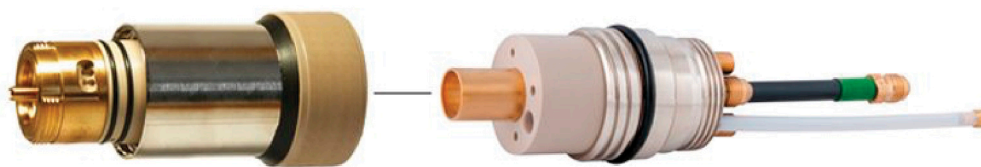

LÍNEA *Hypertherm*® TORCH

POWERMAX 45

No.	Order No.	Description
1	228320 088008	Cuerpo torch machine Torch 088008 +45U

POWERMAX 65/85/105

No.	Order No.	Description
1	059473	Torch Hand Duramax 7,6 m
2	059476	Torch Machine Duramax
3	059481	Torch Hand Mini 7,6 m
4	228788	Torch Hand Retro Fit 1250/1650
5	228790	Torch MachineRetro Fit 1250/1650
6	228954	Empuñadura Torch Hand
7	059264	Torch Hand 7,6 m
8	059265	Torch Machine 7,6 m
9	059262	Torch Machine 15 m
10	059325	Torch Machine

POWERMAX 65/85/105

No.	Order No.	Description
1	228716	Cuerpo Torch Machine
2	228735	Mounting Sleeve Mini
3	228736	Adapter Ring Mini
4	228737	Torch Sleeve Largo
5	228958	Cuerpo Torch Hand
6	228959	Cable Torch 15 m
7	228730	Cable Torch Mini



LÍNEA Hypertherm®

**POWERMAX
85
105**

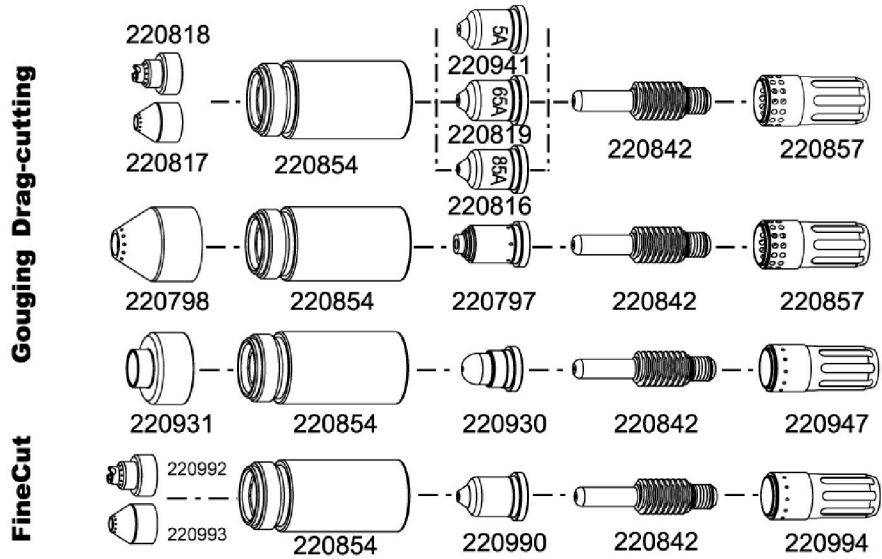

**POWERMAX
125**

No.	Order No.	Description
1	428147	Cuerpo Torch Machine
2	420158	Nozzle 45A
2	420151	Nozzle 45A Fine Cut
2	420169	Nozzle 65A Fine Cut
4	420000	Shield
4	420152	Shield Fine Cut
6	420159	Swirl Ring
5	420153	Retaining Cap
7	420971	Electrodo

